

# Camping POD - S

# Plan and 3D cut view

Camping POD- S is a new design camping / garden house for year-round use. The Entrance is designed in a way, that you can use the most out of your space. The building does not require concrete base and is very easily mountable.

## Camping POD- S Specifications

- Length 6,47m
- Width 2,43m
- Height 2,65m
- Floor area 11,7 m<sup>2</sup> (livingroom 8,5 m<sup>2</sup> + bathroom 3,2 m<sup>2</sup>)
- Electric floor heating
- Water heater 80 l (under the basin worktop)
- Wc and shower
- Glass wall, double glazing
- 1 openable window ( ISO), PVC frame
- Lockable door with glass ( ISO) PVC frame
- LED strip lighting, switches and sockets

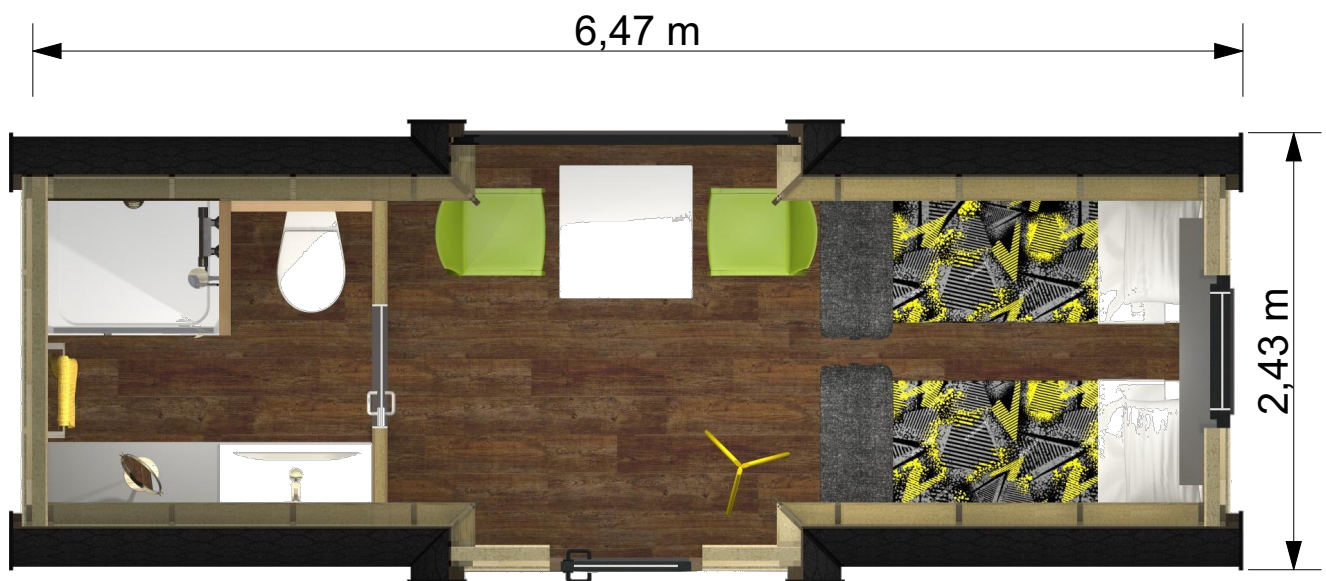

Plan



3D cut view

# Camping POD - S

# Room plan

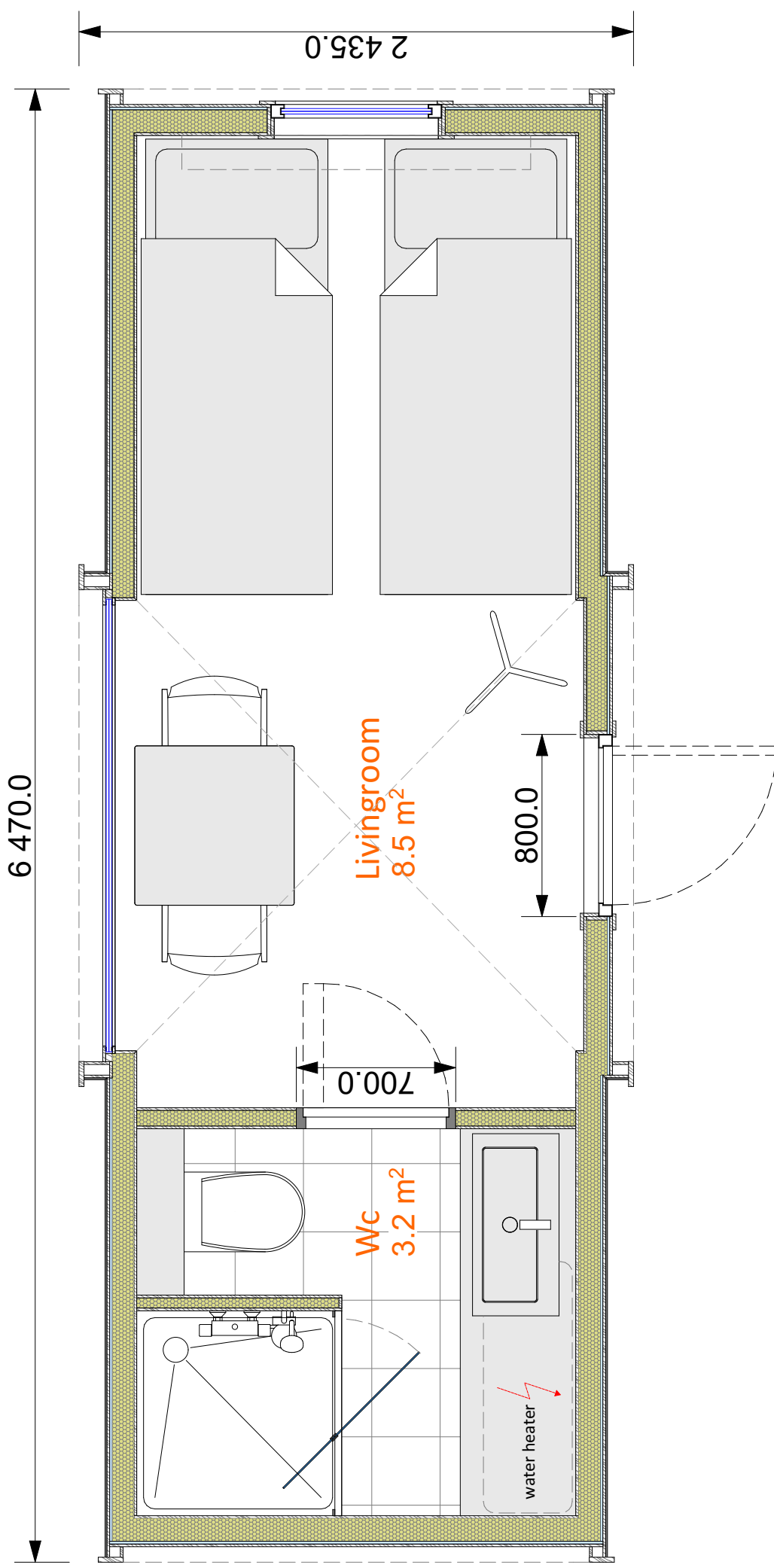



Front view

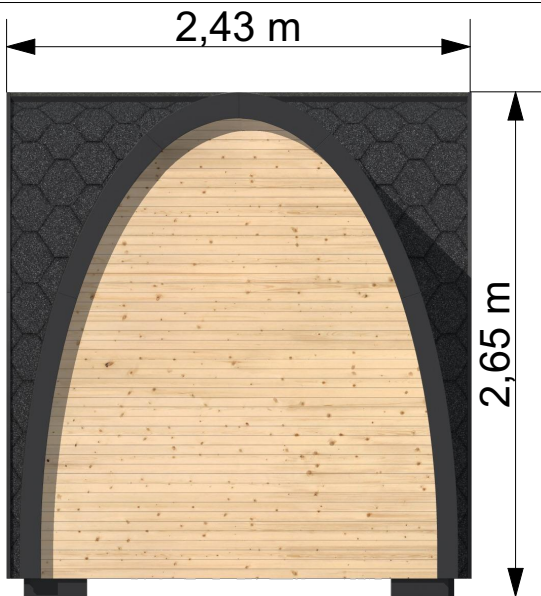

Right view

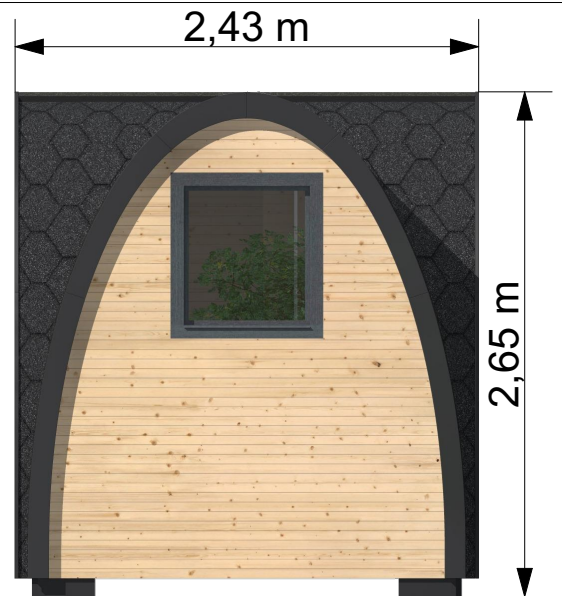

Left view



Rear view

