

# Tub Ø 120 cm.

## Details list.

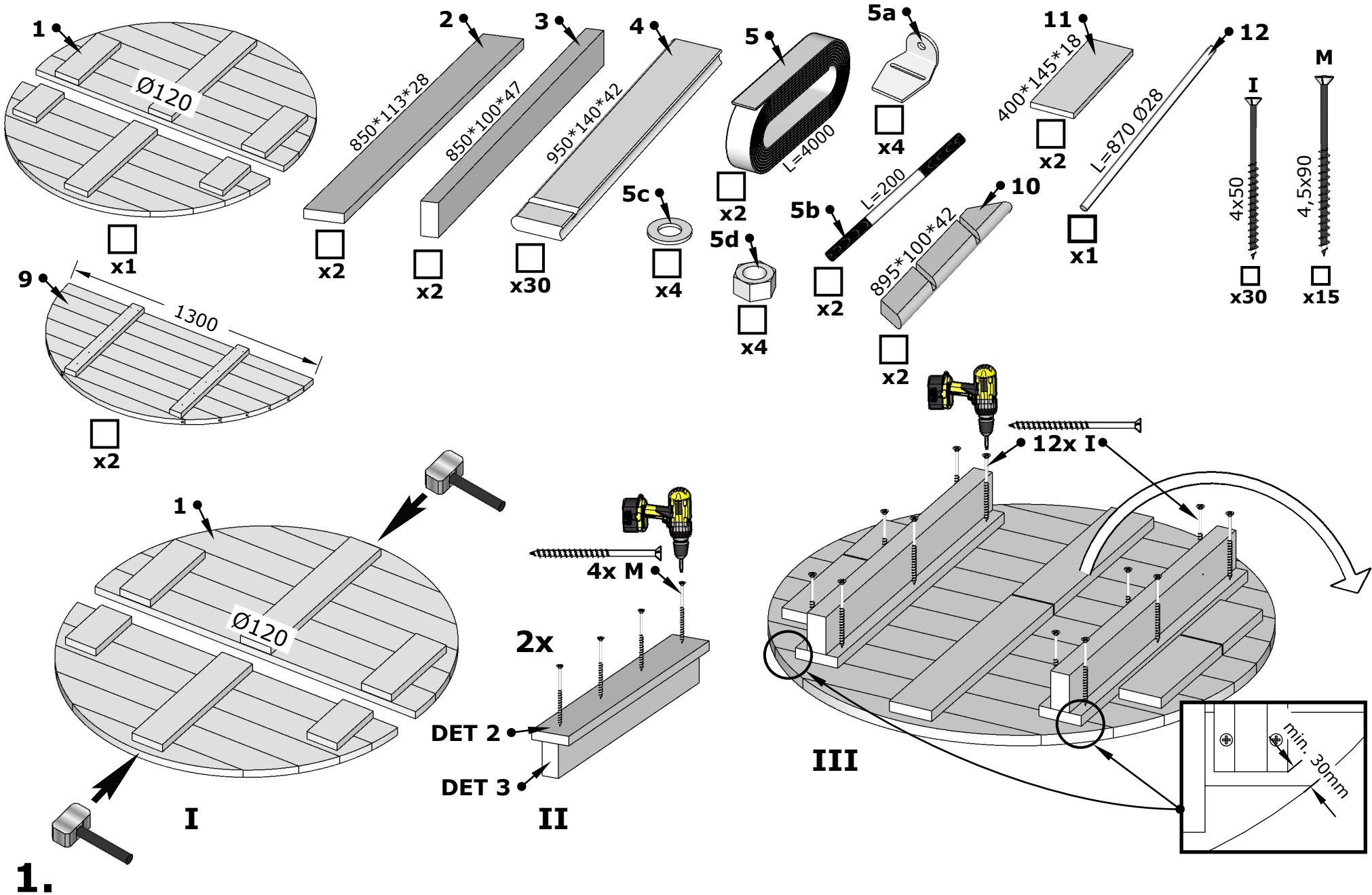

# Tub Ø 120 cm.

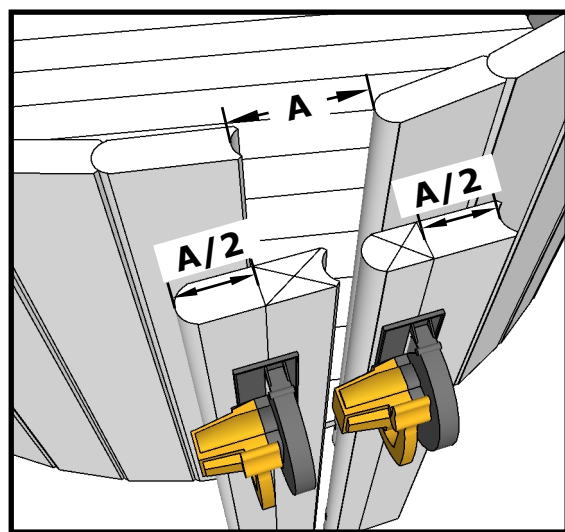
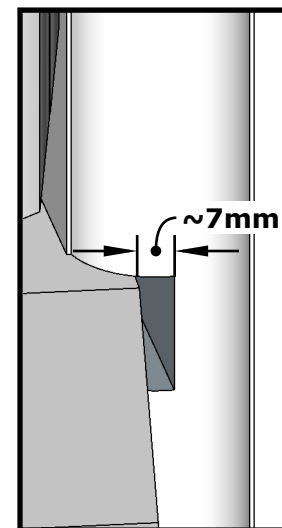
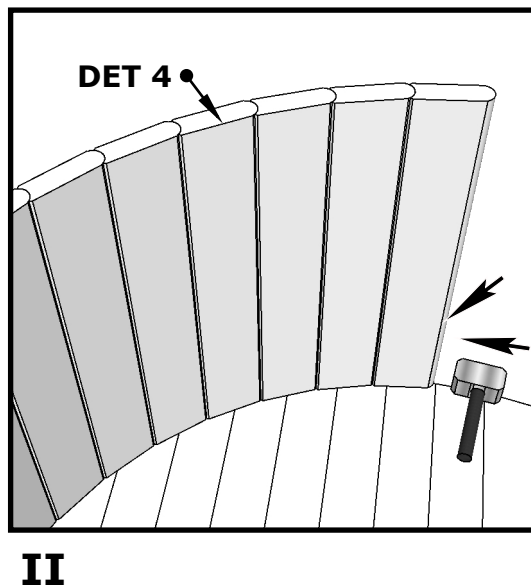
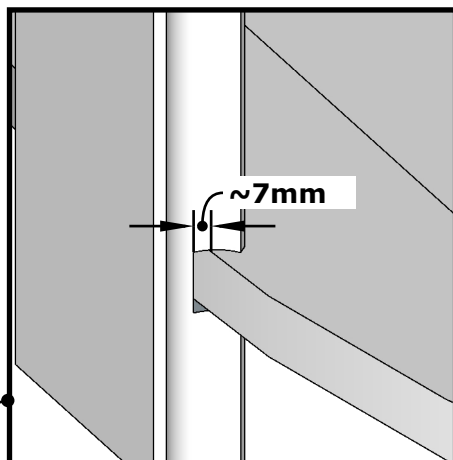
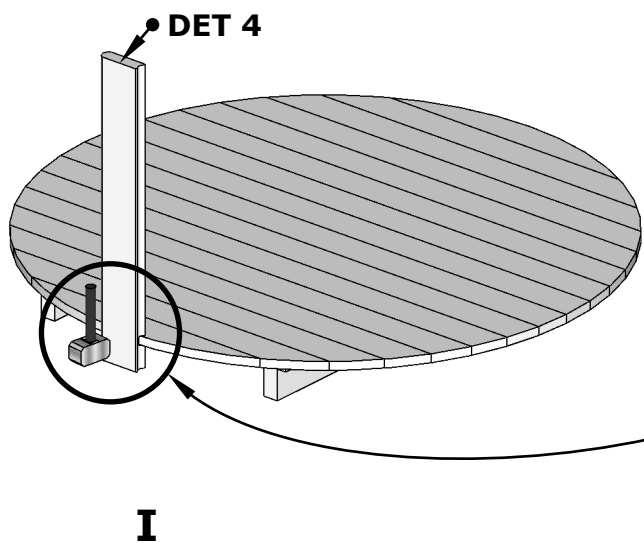

**2. III**

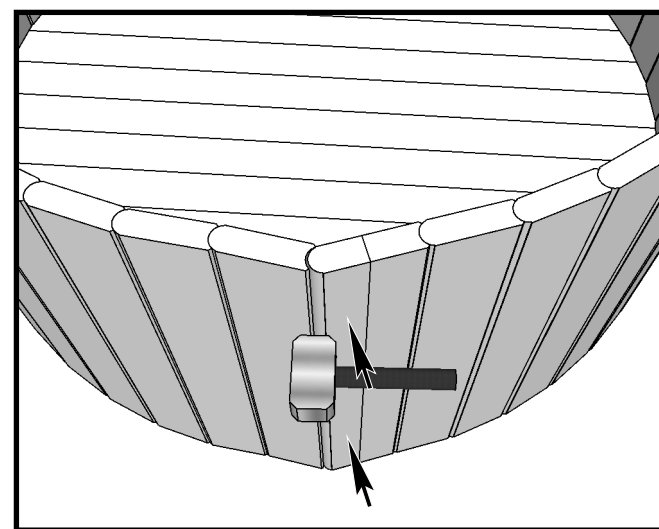
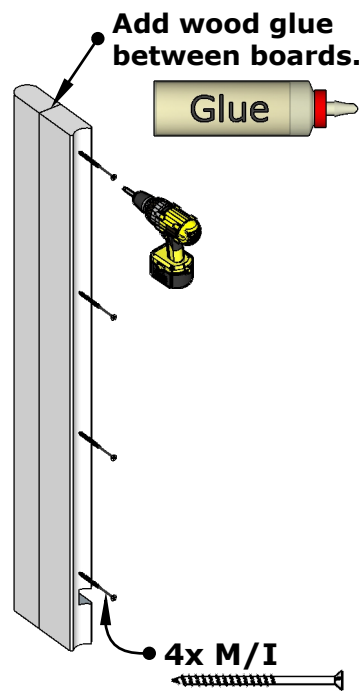

**IV**

# Tub Ø 120 cm.

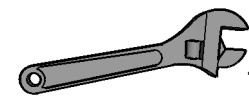
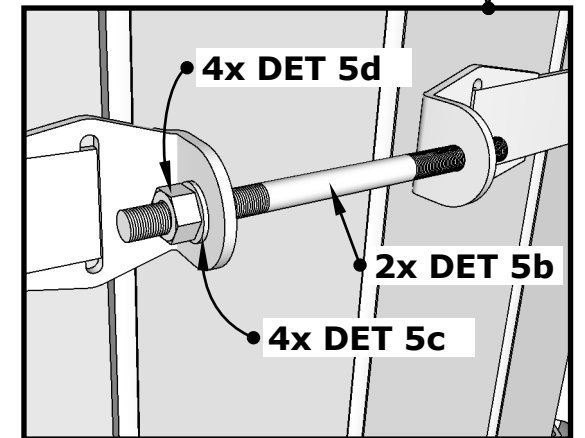
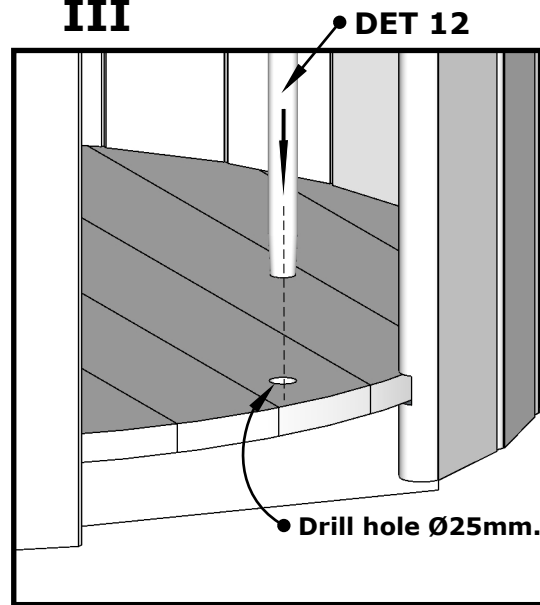
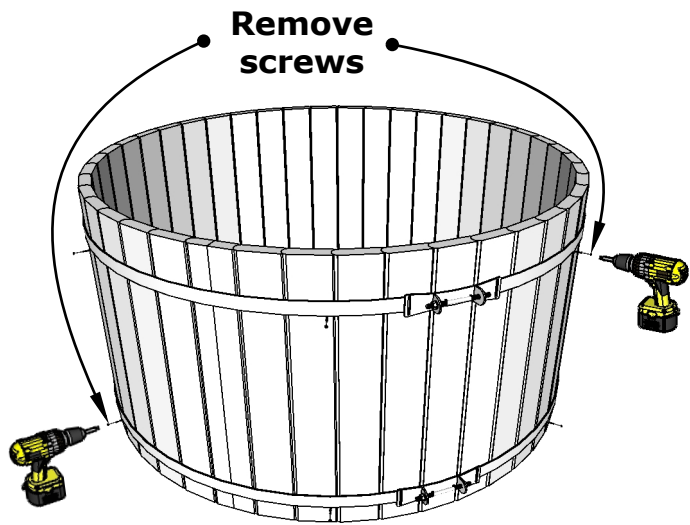
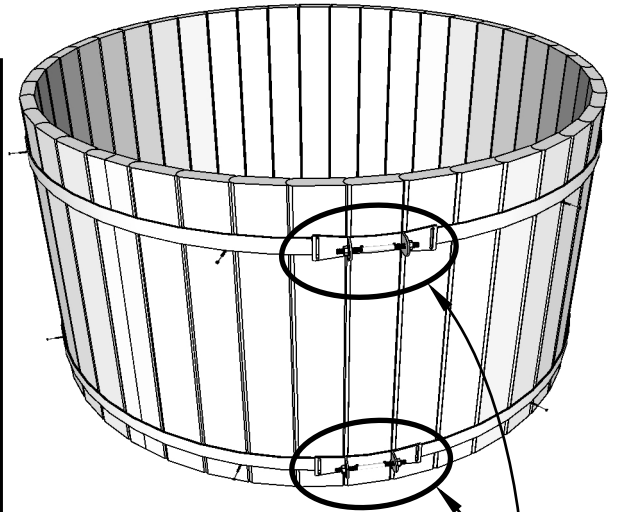
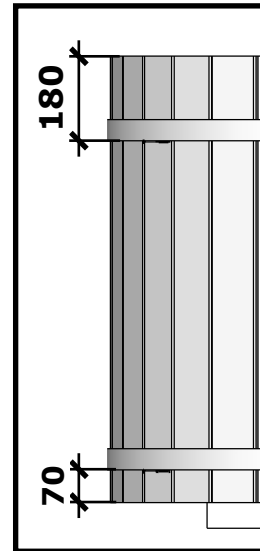
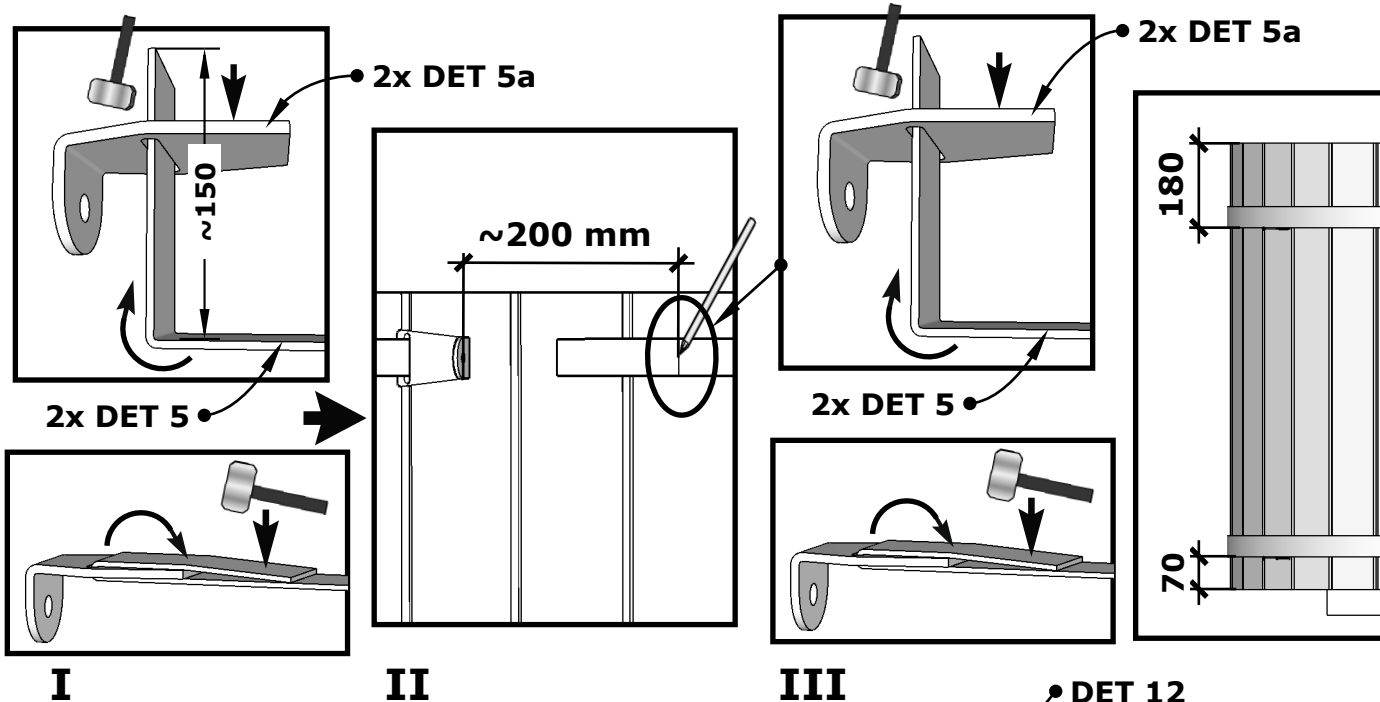

During assembly and retightening the threaded rods, use oil (Würth HPS 1400 or similar) to avoid "cold welding" and it is also easier tightening.

**NB!** Be careful, do not hit the bottom beams.

# Tub Ø 120 cm.

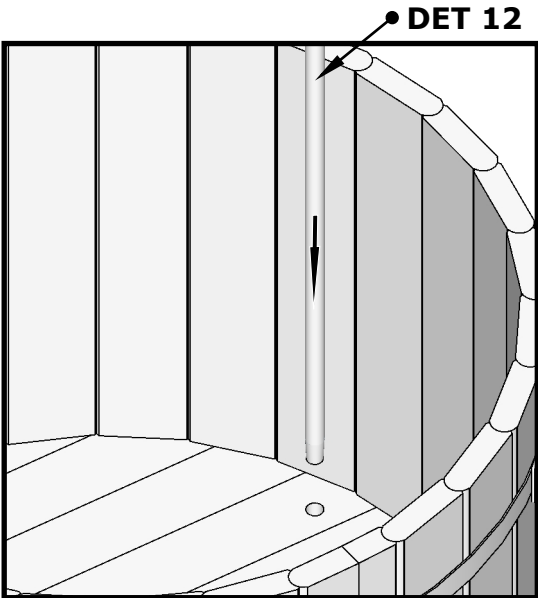

I

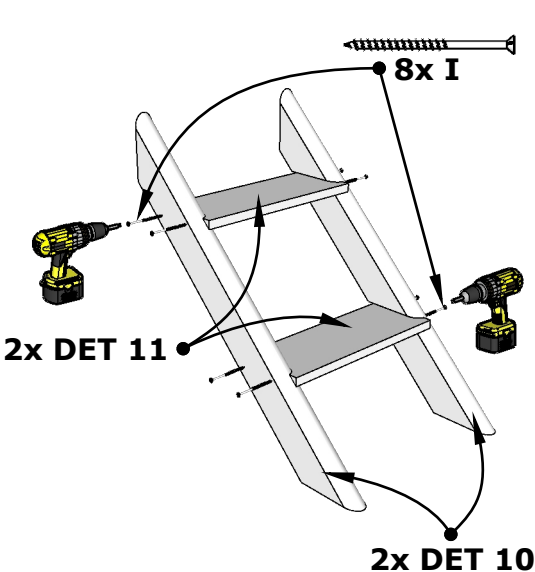

II

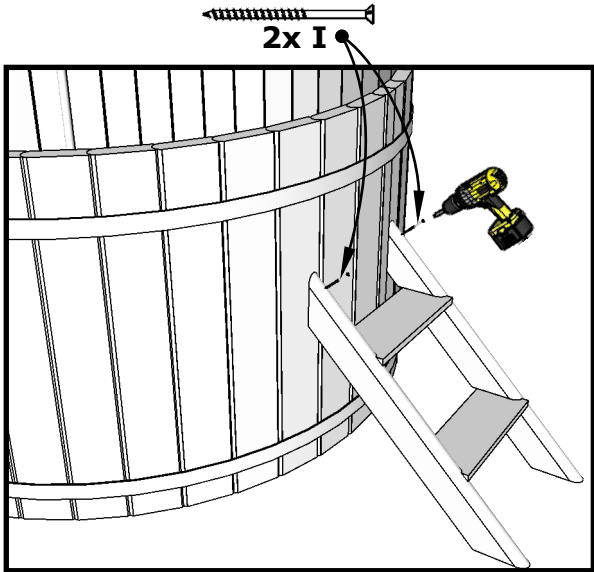

III

