

## 1. PRODUCT DIMENSION

Parts and dimensions

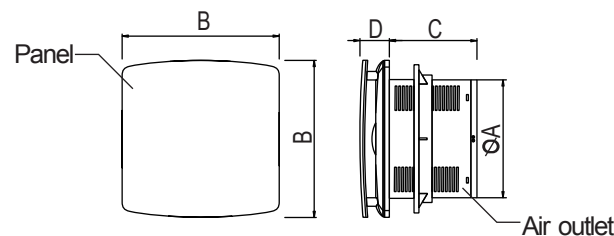

Unit: mm

Model	ΦA	B	C	D
100mm (4*)	100mm	150mm	90mm	35mm
150mm (6*)	150mm	193mm	100mm	35mm

## 2. TECHNICAL PARAMETERS

Notice: Below parameters are just for reference. Detailed should subject to the ones on the product nameplate.

Model	Voltage	Frequency	Power	Air Volume	Noise
100mm (4*)	220-240V~	50/60Hz	12W	95m³/h	34dB
150mm (6*)	220-240V~	50/60Hz	18W	240m³/h	35dB

## 3. WIRING DIAGRAM

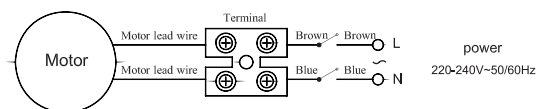

## 4. HUMIDITY SENSOR WIRING DIAGRAM AND INSTRUCTIONS

### 4.1 Humidity sensor system wiring diagram

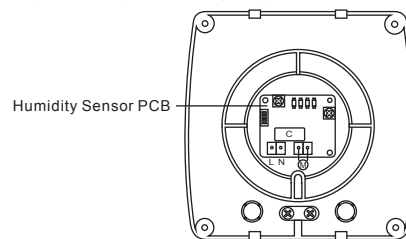

### 4.2 Humidity sensor system humidity-adjusting and time-adjusting diagram

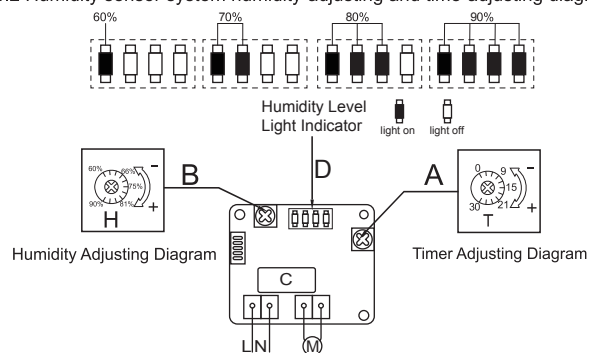

### 4.3 Humidity sensor system using instruction

The extractor fan with humidity sensor turns on automatically when the humidity level in the room exceeds the humidity sensor threshold within 60-90% and operates until the humidity level falls to the set certain level, after that the fan continues operating within 1 to 30min and shuts down. The timer setting is adjustable from 1min to 30min, and the humidity level setting is adjustable from 60% to 90%. The delay timer and humidity level can be adjusted by turning the control knob clockwise to increase and counter-clockwise to decrease, the humidity level light indicator will show as above D. When the fan is in operation, the fan power light will keep on.

## 5. MOTION SENSOR WIRING DIAGRAM AND INSTRUCTIONS

### 5.1 Motion sensor system wiring diagram

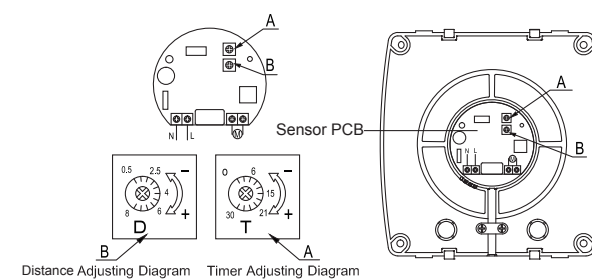

### 5.2 Motion sensor system performance specification

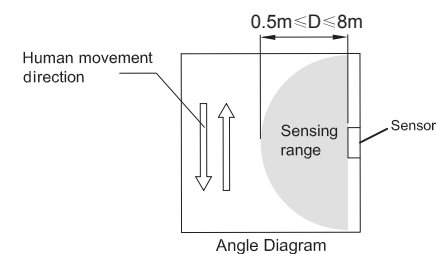

Sensing Distance	Angle	Delay Time	Working Temperature
0.5m ≤ D ≤ 8m	180°X360°	1-30Min	-15℃-40℃

### 5.3 Motion sensor system using instruction

The extractor fan with motion sensor turns on automatically when detecting movement in the distance range of 0.5m ≤ D ≤ 8m and the detection angle up to the 180°X360° and operates until the motion is away, the fan will continue operating within 1min to 30min according to the timer setting and afterwards shut down, the sensing distance can be adjusted from 0.5m to 8m, The delay timer and distance can be adjusted by turning the control knob clockwise to increase and counter-clockwise to decrease, the factory original distance setting is 0.5m, timer setting is 1min.

## 6. TIMER SYSTEM WIRING DIAGRAM AND INSTRUCTIONS

### 6.1 Timer system wiring diagram

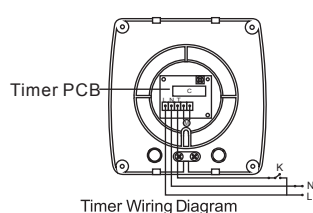

### 6.2 Timer system time-adjusting diagram

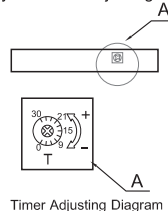

### 6.3 Timer system using instruction

The extractor fan with timer turns on when there is power input supplied by control voltage. The timer will enable the fan to continue operating 1 to 30mins according to the timer setting after the fan switched off. The delay timer can be adjusted by turning the control knob clockwise to decrease and counter-clockwise to increase.

## 7. INSTALLATION DIAGRAM

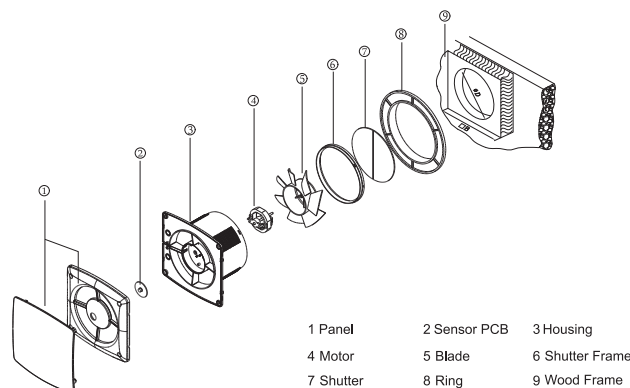

## 8. CAUTIONS

- Installation height: more than 2.3m from floor.
- Never install the fan into ceiling, or the place where it would be exposed to water splash, excess vapor or high temperature. Never install ducts into flue with poisonous gas.
- When using switch to control power, avoid to turn on/off the switch frequently. Turn off switch if the fan is not used for long time.
- Avoid the air back into room through the open flue or other open-flame appliances.
- If the supply cord damage, must be replaced by staff specialist from maintenance department of manufacturer or similar specialized electrical personnel, using specialized cord or from manufacturer or maintenance department.
- This appliance is not intended for use by persons (including children) with reduced physical, sensory or mental capabilities, or lack of experience and knowledge, unless they have been given supervision or instruction concerning use for the appliance by a person responsible for their safety. Children should be supervised to ensure that they do not play with the appliance.
- A multi-pole switch must be used to install the appliance. The gap between switch continues must be no less than 3mm.
- Vent cover should be installed to prevent the ingress of water and vermin.

## 9. MAINTENANCE

- Switch off power at first.
- Removing louver hood, cover, blade and so on, wash them in water with brush. Using soft cloth to wipe off grease with neutral cleanser. Never use water over 60℃, petrol, benzene, thinner or any other such organic solvent to clean. Do not allow water to enter into motor.
- Dry the cleaned parts by itself or soft dry cloth. Then reset in turn.
- Within guarantee, under normal operation, any malfunction caused by manufacturer can be repaired or replaced freely.
- Carry out lifelong maintenance, exceed guarantee time, shall collect cost fee of parts and materials.
- Guarantee is not applicable to following cases.
  - Used or exchanged the parts made by other company.
  - Failure caused by wrong operation, maintenance or repair, force majeure and so on.
  - No invoice, no stamp of appointed sellers or no date.

## Wall/Window Type Extractor Fan Operating Instruction

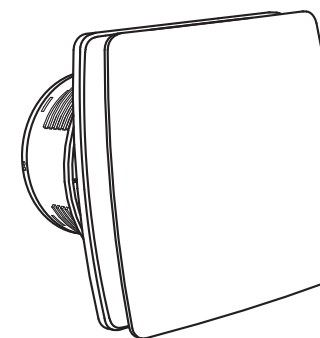

- 100mm (4\*)
- 150mm (6\*)